

THE POLY'S SPRING GALLERY



On the ground floor of The Poly
Located directly on Falmouth's high street
Dimensions: 8.4m x 3.6m
Capacity: 50 people standing

EXHIBITING IN THE SPRING GALLERY

- The Poly is open Tuesday – Saturday. Monday is hanging day (10am – 5pm) and take down is by 5pm on Saturday, unless alternative arrangements have been made.
- Private views are usually held, if you want one, on the Tuesday evening 5pm – 7pm.
- We are an [Own Art](#) gallery, so can set up loans allowing someone to spread the cost of work (costing £100 - £2500) over 10 months, interest free.
- We host your exhibition on our website and promote it in our weekly newsletter and regular social media presence. We ask for a handful of images – in the case of group exhibitions, one or two images per artist – and, unless you wish to make your own poster, one image that we can use on a poster for street advertising.
- Hirers invigilate their own exhibitions or organise for a friend to be there in their place. The exhibition can be left without an invigilator, but The Poly is not responsible in the very unlikely event of anything happening to the artwork.

- We use a Cobra hanging system which makes things nice and easy. You are permitted to use other fixings (nails etc) but all holes must be made good by filling, sanding and painting at the end of the show.
- Members of The Poly receive a £20 discount when hiring the gallery.

HANGING SYSTEMS AND DISPLAY ADVICE

The Spring Gallery and Main Gallery use the 'Cobra' hanging system. This is a system of wire/nylon cords hung from rails connected to the wall. Once hung a 'zipper' is slipped onto the wire. It is easily adjustable for work and more than one can be used on a single wire.

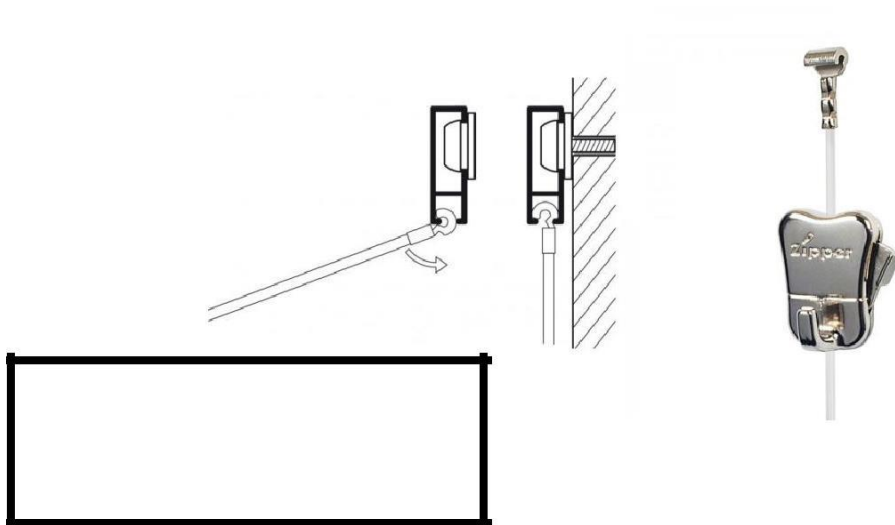

Metal Cords Max weight- 20kg

Nylon Cords Max weight-15kg

To make the most out of this hanging system we suggest that D- rings are used when hanging pictures (one each side) where possible. This will allow the picture to sit flush to the wall when hung from two lines.

Other methods do also work, but results may vary depending upon the size of work to be hung.

ON NO ACCOUNT MUST YOU CUT THE CORDS! If they are hanging below your work, please roll the wire up and put the behind the picture.

[Blu Tac](#)

Please do not use Blu-Tac on any of our walls. If you need to affix a sign to a wall, please use White Tac.

Other

Nails, screws, etc.: These should NOT be used for the display of work or signage. Please ask in advance of your exhibition for guidance on alternate methods.

If you do mark or damage the walls in any way, this must be made good to The Polys satisfaction by 19:00 on the last day of your hire.

If an exhibitor is unable to use our normal hanging system, they can, with prior agreement from a member of staff, use other systems such as screws and raw-plugs directly into the walls. In this case, an additional deposit of £50 will be taken, to be refunded if the exhibitor makes the walls good to a satisfactory standard after their exhibition is over.

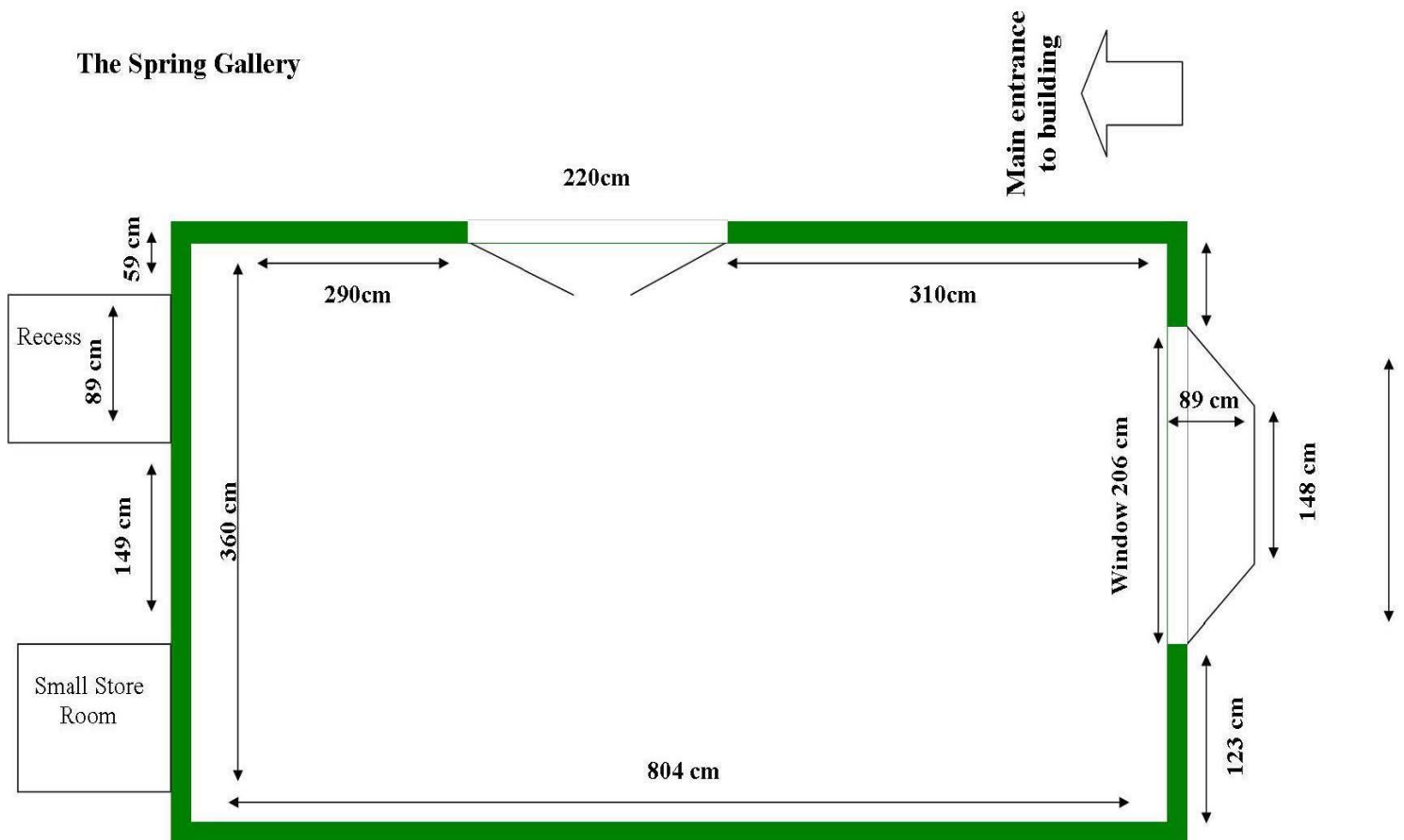

This layout is intended for guidance only space and layout are subject to change